

**BLOOMFIELD BUSINESS PARK  
404 BLOOMFIELD DRIVE  
WEST BERLIN, NJ 08091**

**INDUSTRIAL  
INVESTMENTS**



- 10,500 SF Building
- Five Tailgate Docks and Two Drive-In Doors
- Excellent Location on Route 73
- Minutes from NJ Turnpike, I-295, Route 30, Route 38, Route 70, and Philadelphia



**FOR MORE INFORMATION: | 215.542.8017 | [INDUSTRIALINVESTMENTS.COM](http://INDUSTRIALINVESTMENTS.COM)**

# BLOOMFIELD BUSINESS PARK 404 BLOOMFIELD DRIVE WEST BERLIN, NJ 08091

INDUSTRIAL  
INVESTMENTS

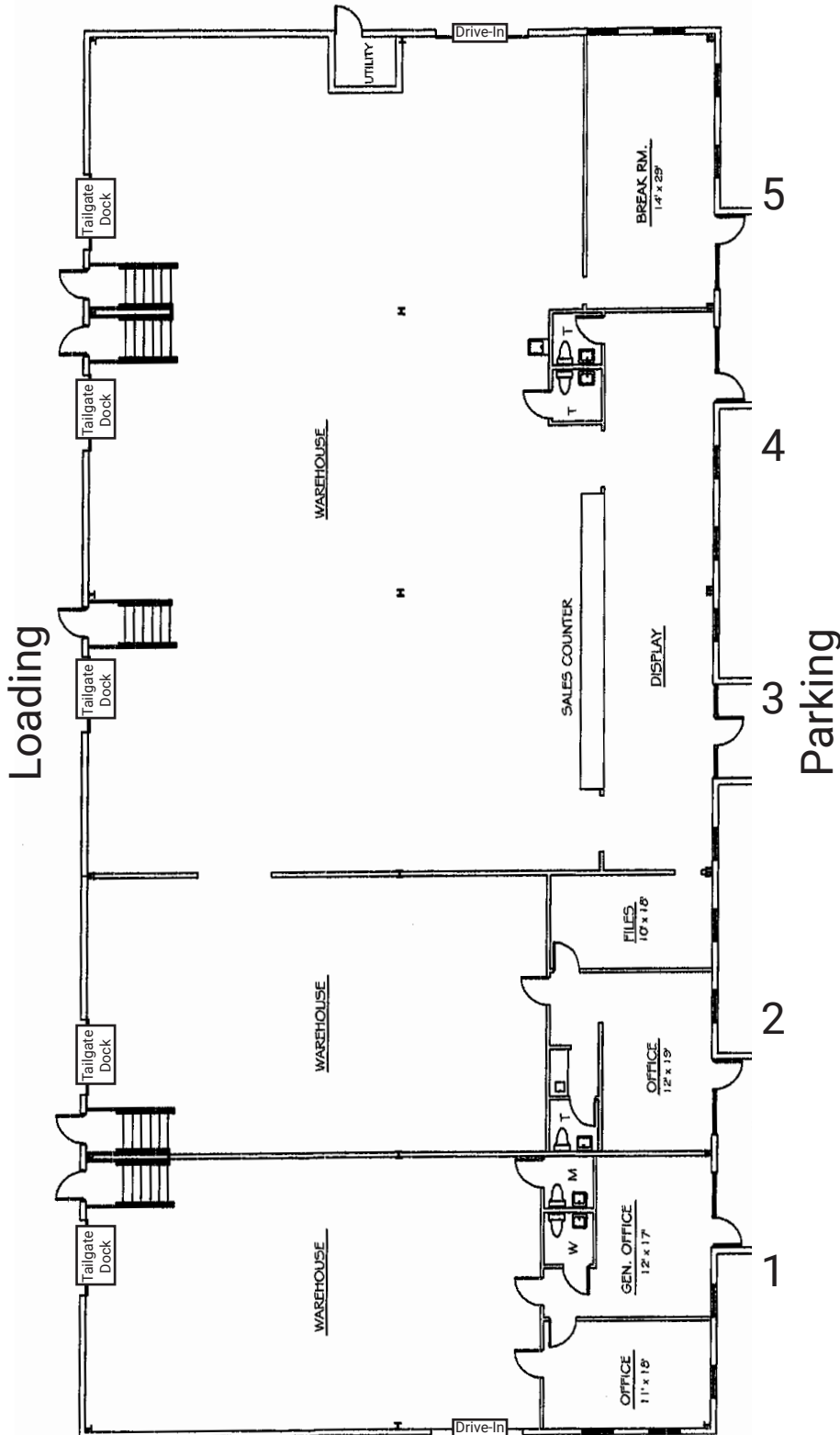

## FEATURES

- Units from 2,100 Sq. Ft.
- Tailgate and Drive-In Loading
- 15' Clear Ceilings
- 3-Phase Power
- Offices-to-Suit
- Public Water and Sewer
- Natural Gas Heating
- Separately Metered
- Flexible C-2 Commercial Zoning
- Master-Planned Business Park

## LOADING DETAILS

- Drive-In Door: 10' W x 12' H
- Tailgate Docks: 8' W x 10' H