

INDUSTRIAL  
INVESTMENTS



# 2445 - 2465 MARYLAND ROAD WILLOW GROVE, PA 19090



## WILLOW GROVE INDUSTRIAL PARK

- Rental Units from 17,760 to 40,000 sq. ft. (57,760 sq. ft. Overall)
- Prime PA Turnpike Frontage - 1/4 Mile to Exit 27
- 6.4 Acre Lot with Expansion Capabilities



For more information please  
visit our website or call:

215.542.8017 | [www.industrialinvestments.com](http://www.industrialinvestments.com)

532 Township Line Road | Blue Bell, PA 19422

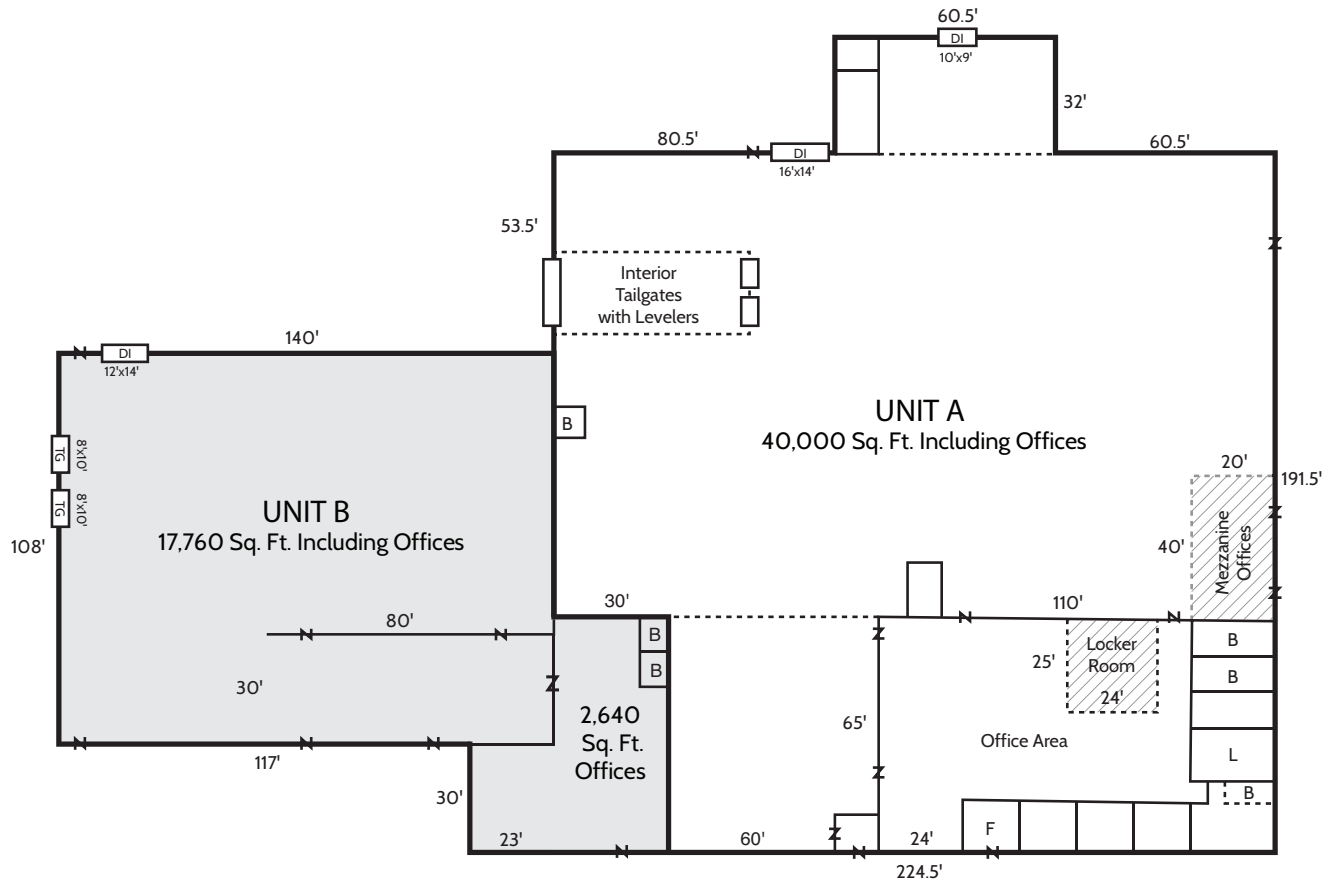

## FEATURES

- Air Conditioned Offices to Suit
- Brick/Masonry/Steel Construction
- Gas-Fired Suspended Heaters
- T5 Fluorescent Lighting
- 40' x 30' Bays (B) and 25' x 20' Bays (A)
- 17' Clear Ceilings
- 400 Amp 480 Volt 3-Phase Power (4160 P.D.)
- Tailgate and Drive-In Loading
- Ample Parking
- Public Water and Sewer
- Light Industrial Zoning
- Owner-Operated

### BROKERS PROTECTED

The information herein is from sources deemed reliable, but is not guaranteed. All measurements are approximate.

For more information please  
visit our website or call:

215.542.8017 | [www.industrialinvestments.com](http://www.industrialinvestments.com)

532 Township Line Road | Blue Bell, PA 19422